



Questions?

Call us Toll Free at:

1-888-648-4923

(Mon-Fri, 9AM-5PM, EST) or email Mike Meditz at: mike@kaiserwillys.com

Turn switch install pointers

First, disconnect the battery. Remove the steering wheel using a steering wheel puller. Unplug the harness at the base of the steering column, also unplug the flasher wire and hazard wire. You also need to remove the 6-wire plug end and both plug ends for the two flasher wires. Now unscrew the 4 machine screws that hold the turn switch and hazard switch in the column, also unscrew the turn signal arm. Pull the harness up and out of the top of the column.

With the old switch out of the way, remove the two machine screws in the flange (#34 in the diagram). Removing these will let the steering column housing (# 32 in the diagram) slip it down to the bottom of the column and out of the way. When you look at the diagram, you can now see the two column holes for the wire loom, you can now stuff one at a time into the top hole and out the bottom hole. Once you have all 9 wires (8 harness and 1 horn wire) pulled out the bottom hole and reinstall the housing to the flange. Now position the wires in the switch so they are out of the way of the turn switch. I've attached a few photos of how the wires should look prior to installing the switch and after the switch is installed. The hazard red stem has to be firmly pulled out for normal running and firmly in for hazards. If it gets placed in the middle position, you will experience lighting abnormalities.

Jeep did funny things along the way and also since your Jeep is 50+ years old, things get hacked and changed. The best way to verify the wire colors and to pin the plug correctly is to do the following: Using a 12V source, attach ground to the body and test each pin in the Jeep side plug. For example, 12V to the blue wire should turn on the left rear turn light. Then since you know that is correct, you can pin the blue wire in the corresponding spot on the cancelation side plug. Do LF, RF, LR and RR to understand how your Jeep is wired.



Questions?
Call us Toll Free at:
1-888-648-4923
(Mon-Fri, 9AM-5PM, EST) or email Mike
Meditz at: mike@kaiserwillys.com

Directional/hazard wiring diagram

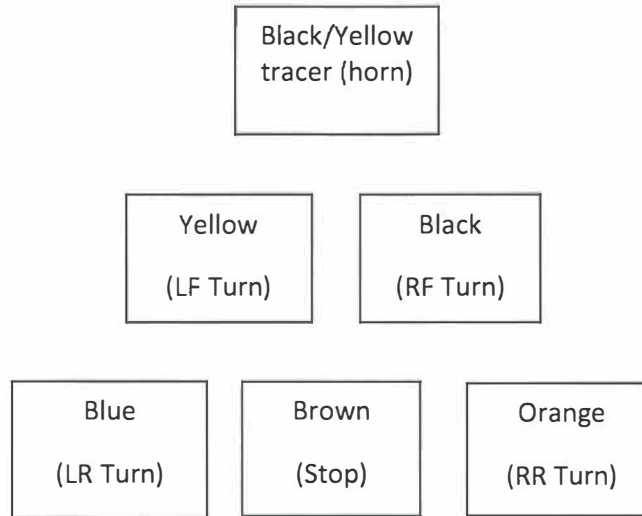

*** NOTE: This diagram is viewed as you are inserting (pinning) lugs into the plug housing on the cancelation switch side***

Pink: To hazard relay (flasher), the other side of the relay goes to the circuit breaker above the dimmer switch on the driver side footwell, this gives constant 12V (Flashers will work with key off)

White: To turn signal relay (flasher), the other side of the flasher gets power from the ignition switch, this gives switched 12V

Yellow: Left front turn light

Black: Right front turn light

Black/Yellow: Horn

Blue: Left rear turn light

Brown: Stop light

Orange: Right rear turn light

Note: These wire colors are for the Jeepster Commando models, different model Jeeps may use a different wire color scheme

STEERING
Group 23

JEEPSTER SERIES VEHICLE PARTS LIST

STEERING
Group 23

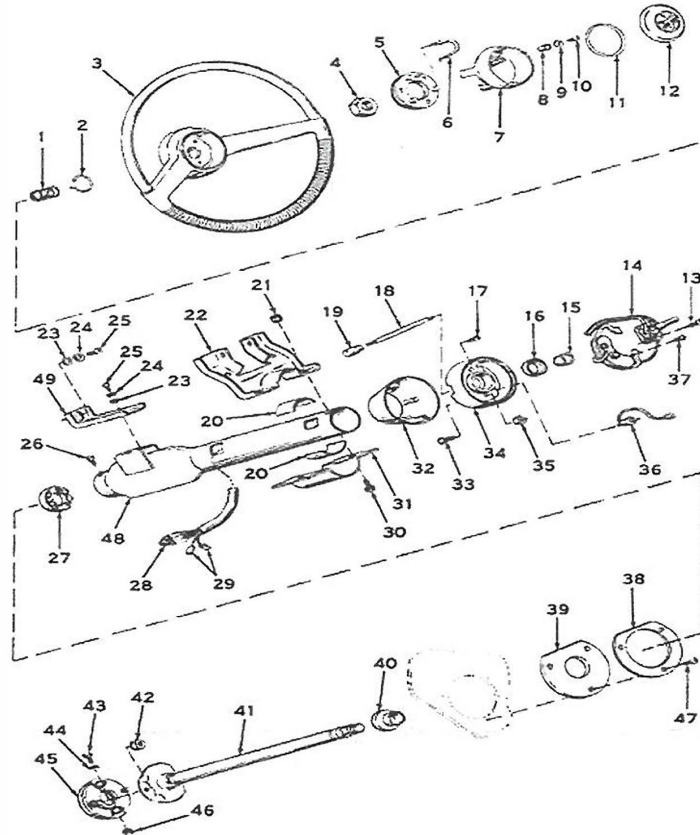

200

Figure No. 80 - Steering Column

